

## TM 501002L Conical Single Roller Foundation DIN Shape



**Type A**



**Type B**

See reverse for details ⇒

**TECH-MARINE EQUIPMENT APS**  
**ESRUMVEJ 421 • 3080 TIKØB • DENMARK**

E-mail: [Tech-Marine@Tech-Marine.dk](mailto:Tech-Marine@Tech-Marine.dk) • [www.Tech-Marine.dk](http://www.Tech-Marine.dk)  
Phone +45 4970 4395 • Fax + 45 4970 1769 • CVR 25 99 96 49

## Conical single roller foundation

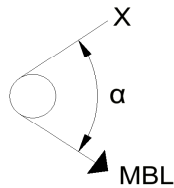
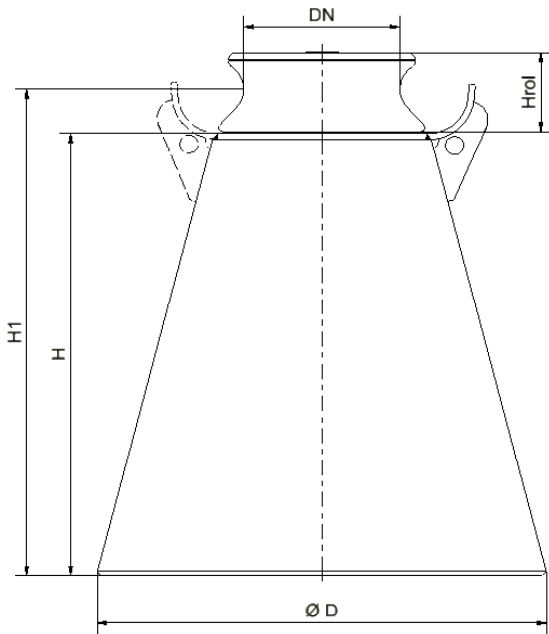

**Material:**

Foundation: S355J2 - EN10025 or equivalent

**Certificate:**

3.1 acc. To EN 10204:2004

**Surface Treatment:**

Abrasive blasting Sa 2.5  
 External: 25 micros of Hempel's shopprimerZS 15890  
 Internal: Two layers 125 micron Hempel Hempadur 45143 or equivalent

**Type:**

Type A: one Rope Guard  
 Type B: Two Rope Guards

The foundation is in compliance with IMO Guidance, MSC/Circ. 1175 of May 2005 and IACS UR A2 rev. 3.

**Design load 1.25 x SWL**

Allowable stresses 100/60 % of min yield point

Upon installation the supporting structure should be test loaded to the specified SWL and test certificate issued.  
 The test certificate should be available for inspection on board ship.

Suitable strengthening at deck/shell bulwark by the yard.

**ORDER: TM501002L-DN-H1 TYPE**  
**example: TM501002L-DN 450-H1=831 Type A**

Nominal dimensions, in mm		SWL kN	Rope load (MBL) kN	Wind- ing angle Deg.	Dim. in mm	
DN	Hrol				H	D
160	80	404			343	362
					491	443
					591	543
					691	643
					791	743
					891	843
					991	943
					1091	1043
					1191	1143
					1291	1243
200	102	628			351	430
					512	451
					612	551
					712	651
					812	751
					912	851
					1012	951
					1112	1051
					1212	1151
					1312	1251
250	126	913			456	536
					632	556
					732	656
					832	756
					932	856
					1032	956
					1132	1056
					1232	1156
					1332	1256
					1432	1356
320	160	1525			482	633
					675	582
					775	682
					875	782
					975	882
					1075	982
					1175	1082
					1275	1182
					1375	1282
					1475	1382
400	208	1886			457	736
					675	557
					775	657
					875	757
					975	857
					1075	957
					1175	1057
					1275	1157
					1375	1257
					1475	1357
450	256	2084			473	820
					617	573
					717	673
					817	773
					917	873
					1017	973
					1117	1073
					1217	1173
					1317	1273
					1417	1373
					1573	1240
					1617	1473
					1717	1573

### STANDARD

Tech-Marine Equipment ApS Esrumvej 421 - DK 3080 Tikøb Phone. +45 49704395 Fax. +45 49701769 Existing law protects TMs rights of possession to this drawing. The design or the drawing must not, without permission of TM be published, copied, reproduced, manufactured or exploited in any other way.	TM 501002L Conical single roller foundation for Roller type TM 501001L-DIN shape	Date	Checked	Rev.
		21-06-2013		B
		Sheet	2 of 2	